

REMOTE CONTROL

SUBSCRIPTION/ ASSOCIATION / ACTIVATION AND USAGE

This user guide will explain the path that you need to follow to activate Remote Control for your car.

First of all, to use Remote Control, you need a MYPEUGEOT account and register your car. If you haven't yet installed the mobile app on your smartphone, you can easily do it by downloading the app from Google Play Store or App Store.

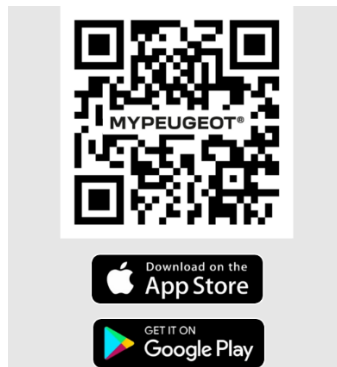

Open the MYPEUGEOT app, visit the Services store section and select “Discover” to activate Remote Control. Tap on “START ACTIVATION” and follow the few steps to activate your new service.

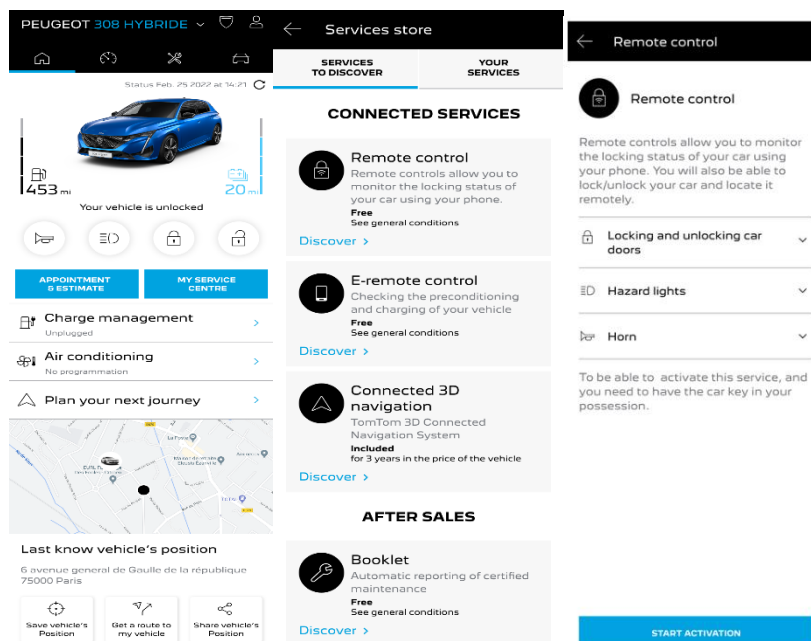

You will redirect to the Service Activation page, in which you can read what Remote Control is and what are the benefits that you will have thanks to this service. Scroll down and tap on the “GET” button to continue activating the service.

To activate Remote Control is important to read and accept the General Conditions and, after saving your preferences, you can start the activation process through the Mobile App, just tapping on “CONTINUE TO MYPEUGEOT”.

The next 3 steps that you need to follow will only take you a few minutes after which you can start enjoying your Remote Control. At the beginning, confirm that you have already read and accepted the terms and condition, then start the activation.

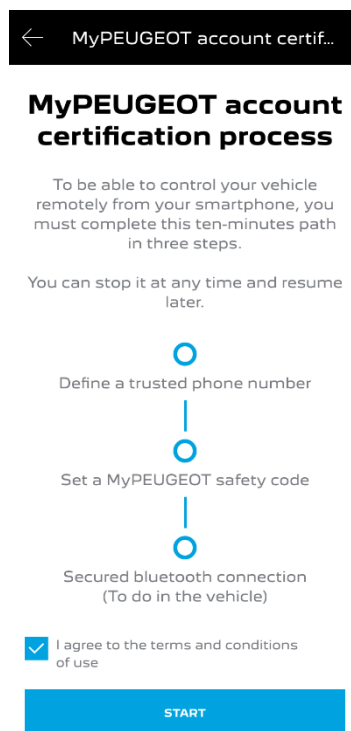

1. Enter your phone number and enter the code that you received via SMS



2. Create your personal 4-digits Safety Code. To start this step, you will receive a temporary code via SMS. First insert it to register your phone and then create your Safety Code. This code will allow you to secure remotely access to your car and to use the Remote Control features.

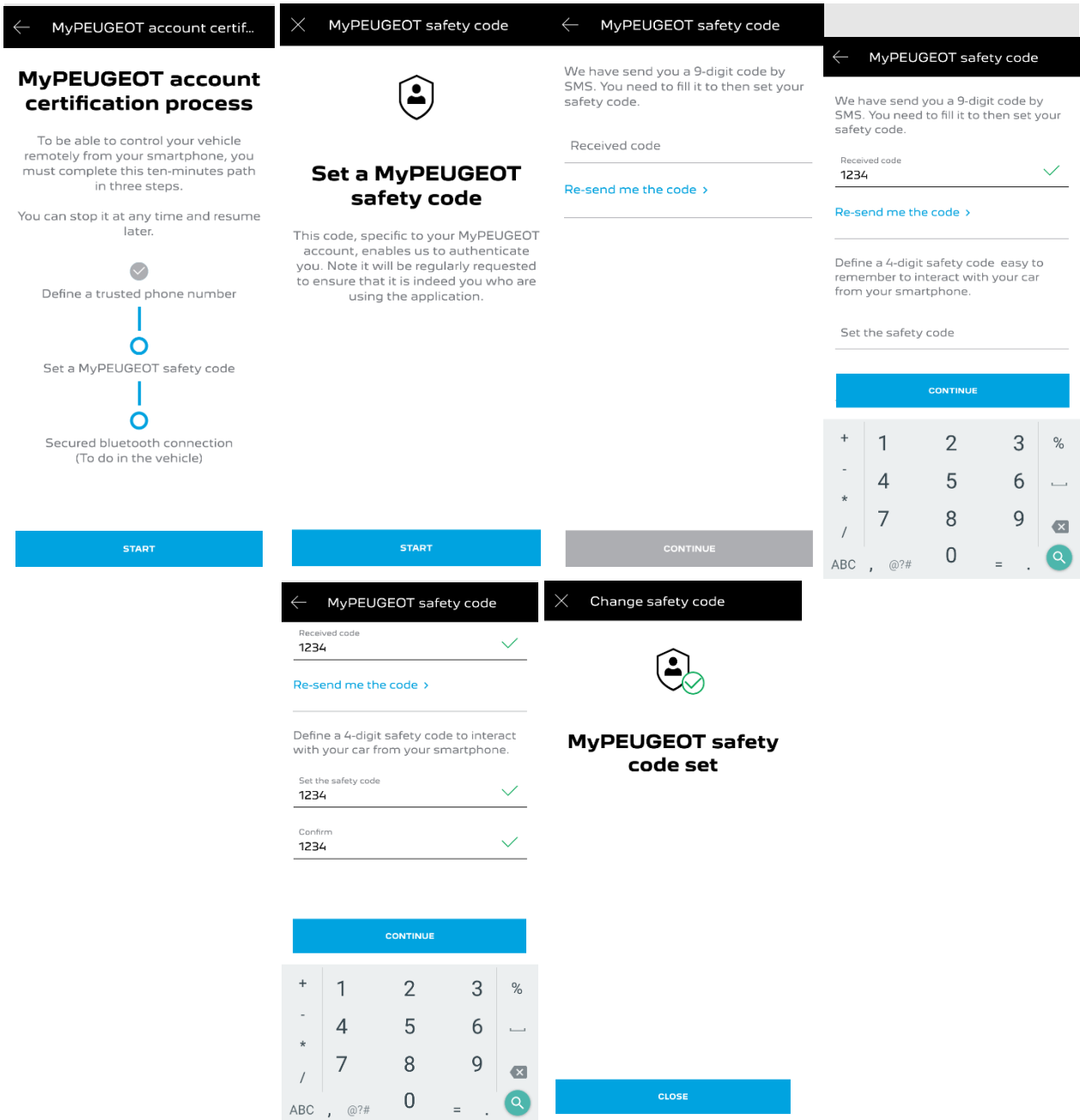

3. Connect your mobile phone to your vehicle using Bluetooth. Go on your vehicle, turn on the engine, turn on Bluetooth on your mobile phone, and click on "PAIR" to start the association.

← MyPEUGEOT account certif...
✕ Secured bluetooth connect...
← Secured bluetooth connect...
✕ Secured bluetooth connect...

MyPEUGEOT account certification process

To be able to control your vehicle remotely from your smartphone, you must complete this ten-minutes path in three steps.

You can stop it at any time and resume later.

Define a trusted phone number

Set a MyPEUGEOT safety code

Secured bluetooth connection (To do in the vehicle)

START

Secured bluetooth connection

Pick-up your car key, keep your phone with you, get on board and start the engine.

START

Make sure you are ready

- 📶 Ensure that your smartphone is connected to the Internet via Wi-Fi or cellular (3G/4G).
- 📶 Turn on the engine, connect your smartphone to your car with bluetooth connexion then click on « Next »
 - [Connect my smartphone to my car >](#)
- 🔒 Your vehicle's privacy mode (private mode) must allow data sharing.
 - [Handle my car data privacy >](#)

PAIR

Secured bluetooth connection done

FINISH

Now the Remote Control Service is active: you may be asked to update your vehicle equipment software to full enjoy all the features and manage your car remotely.

HOW TO USE YOUR REMOTE CONTROL:

Once you have activated Remote Control for your vehicle, you can control the locking status of your car, lock and unlock the doors or turn on the light and the horn in few simple steps.

To remotely control your car, you need only to open “MYPEUGEOT” app, select the icon of the command that you would like to send to your vehicle, confirm the action and wait few seconds. Remember that each 7 days you need to confirm the remote commands using your safety code.

The image shows three sequential screenshots of the MyPEUGEOT app interface for a PEUGEOT 308 HYBRIDE. Each screen displays the vehicle's status, battery level (453 mi), and range (20 mi). The first two screens show the vehicle is unlocked, while the third shows it is locked. Below the status, there are icons for remote control functions: lock, unlock, horn, and light. At the bottom, there are sections for 'APPOINTMENT & ESTIMATE', 'MY SERVICE CENTRE', 'Charge management', 'Air conditioning', and 'Plan your next journey'. A map shows the last known vehicle position at 6 avenue general de Gaulle de la république, 75000 Paris. At the bottom of each screen, there are buttons for 'Save vehicle's Position', 'Get a route to my vehicle', and 'Share vehicle's Position'.